

④ Connection to Blu-ray/ DVD player/ Gaming consoles

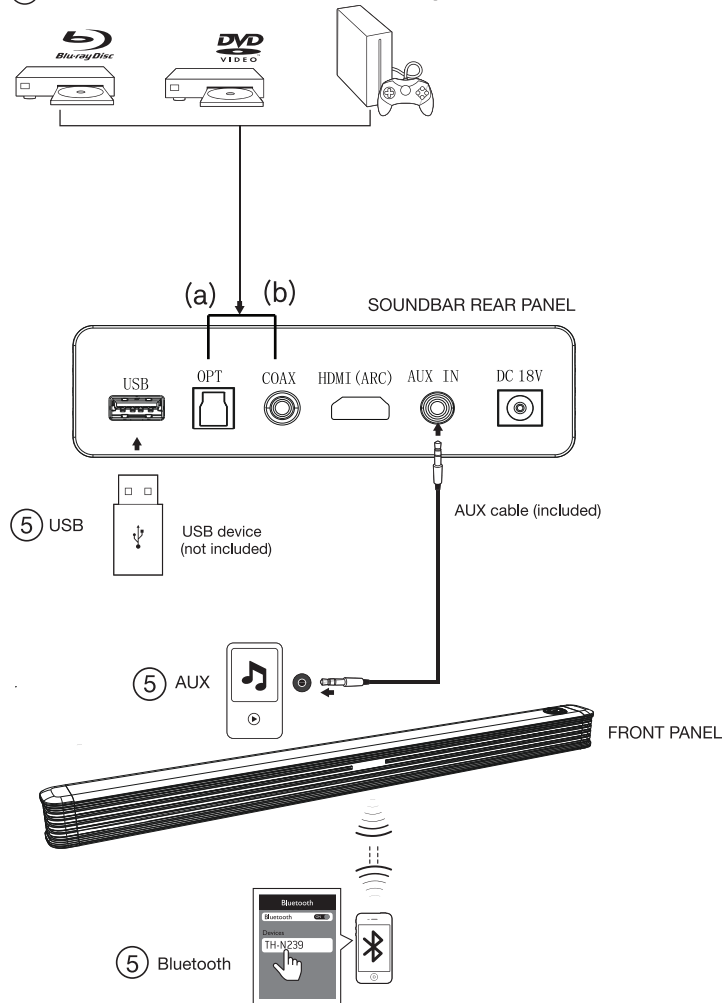

JVC

2.1CH Sound Bar with Wireless Subwoofer

TH-N239BA



USING THE SOUNDBAR

1. Insert 2 x 'AAA' batteries into the remote control.
2. Press Power/Mode button on the Soundbar or the Power button on the remote control to turn on the unit. Set the Power Switch on the rear of the Subwoofer to the On position.
3. Press Power/Mode button on the unit or the Mode button on the remote control repeatedly to select sound source. The display indicates the correct sound source by displaying BT, OPT, COX, AUX, ARC or USB. You can also press the respective button on the remote control to directly switch to a particular sound source.

For more information, refer to the user manual or call Customer Support at 1300 366 155.

QUICK START GUIDE

 Before using this Soundbar, please read all safety information from the user manual.

RECOMMENDED PLACEMENT

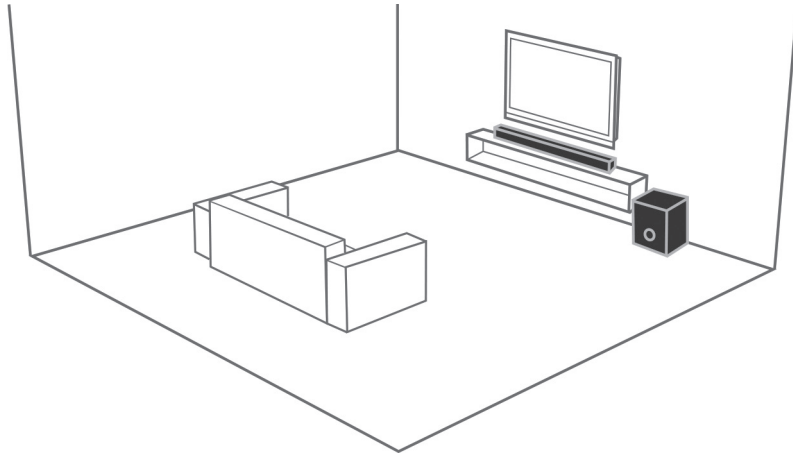

Soundbar: Under a wall-mounted TV, or in front of the TV stand

Subwoofer: On the floor, alongside the TV (or in the front corner of the room)

CONNECTING THE SOUNDBAR TO THE TV

1. Soundbar power connection: First connect the DC output of the power adaptor to the 'DC 18V' port on the Soundbar, then plug the other end of the power adaptor into a mains power outlet.
2. Subwoofer power connection: Connect the Subwoofer's power cord to a mains power outlet. When switched on (On/Off Switch on rear of Subwoofer), the Subwoofer automatically connects to the Soundbar, wirelessly. If the Subwoofer does not connect automatically, follow the pairing procedure mentioned in the manual.
3. Connection to TV (select one of these options):
 - 3 (a) HDMI (ARC) on the Soundbar to HDMI Input (ARC) on the TV (If your TV has an HDMI Input with ARC capability)**OR**
 - 3(b) or 3(c) OPT or COAX input on the Soundbar to the Optical or Coaxial output on the TV**OR**
 - 3 (d) AUX IN on the Soundbar to Headphone out on the TV

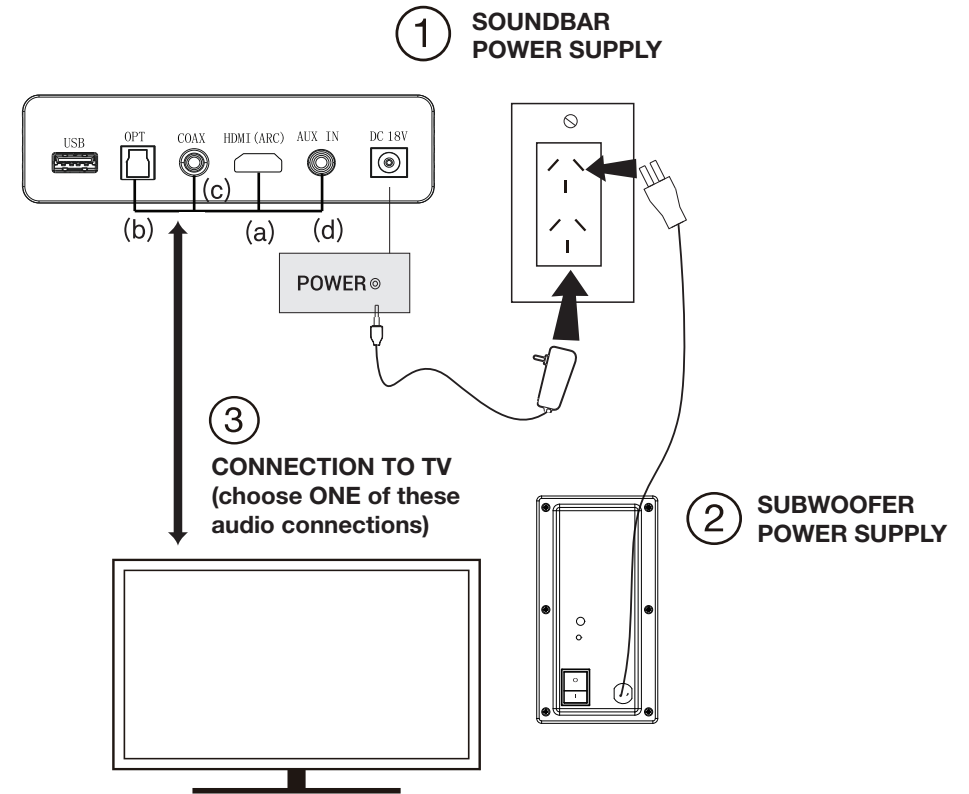

CONNECTING THE SOUNDBAR TO OTHER DEVICES

4. Connection to Blu-ray/ DVD player/ Gaming consoles: Enjoy sound from these devices on the soundbar using one of the connections below.
 - 4 (a) OPTICAL Input on the Soundbar to OPTICAL Output on the source device**OR**
 - 4 (b) COAXIAL Input on the Soundbar to COAXIAL Output on the source device
5. Other audio sources: Bluetooth/ USB/ Aux